



ZOOM USER GUIDE

- 1) **Downloading Zoom Software:** The software can be downloaded from <https://zoom.us/support/download>

Note: To download the software for mobile phones or tablets please search the application in App Store or Google play as “Zoom Cloud Meeting”.

- 2) **Zoom Software Set Up:** Please run the software downloaded from the given link.

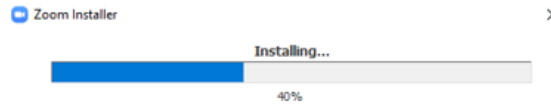

- 3) **Zoom Software Usage:** You can launch the application after the set up by searching the name of the software in your computer as given in figure below.

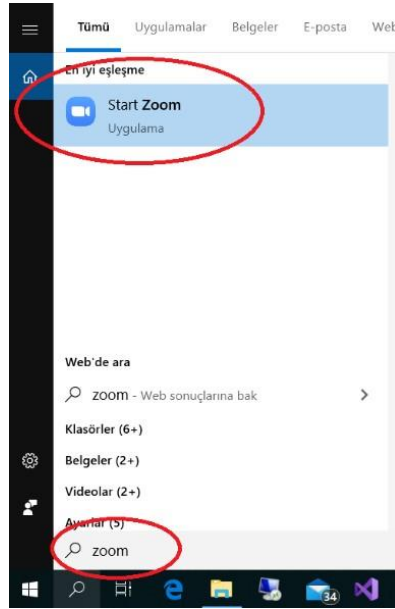

- 4) **Joining IMSEC 2022 Online Sessions:** The participants do not need to sign up to Zoom software to join the IMSEC 2022 online sessions. You can use two different methods to join the sessions.

Method 1: Please login to editorial system (<http://editorpanel.org/imsec2022/>) to reach Zoom Sections infoPlease click on “Join a Meeting” after launching the Zoom software and enter your name, the Meeting ID and the passcode

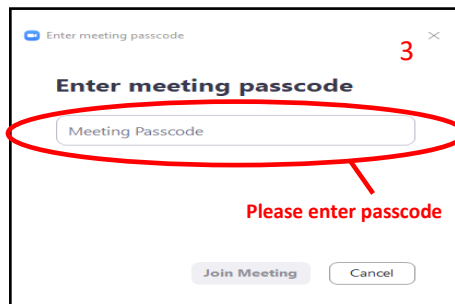
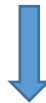
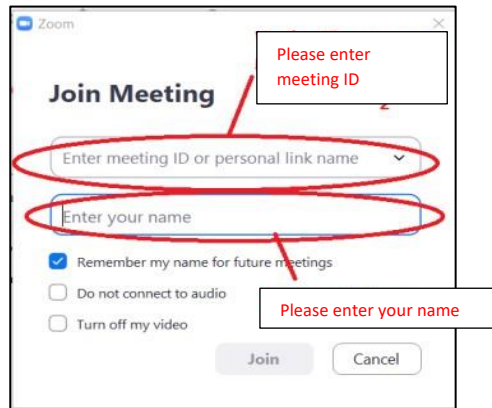

Method 2: You may also join IMSEC 2022 online sessions by clicking the link (“Join Zoom Meeting(which is available in author dashboard (<http://editorpanel.org/imsec2022/>) .

IMSEC 2022 Organising Committee is inviting you to a scheduled Zoom meeting.

Topic: IMSEC 2022 Online Oturum

Time: Oct 25, 2021 10:00 AM Alanya

Join Zoom Meeting

https://us04web.zoom.us/j/*****

Meeting ID: *** **

Passcode: *****

5) Online Presentation: In the online sessions, the moderator will give permission the participants to share his/her screen to present his/her study. The participants can share their screens by clicking on “share screen button”.

1- LAMİNER VE TÜRBÜLANSLI AKIŞLAR

- **Laminer akış:** düzgün akım çizgileri ve düzenli hareket
- **Türbülanslı akış:** hız çalkantıları ve çok düzensiz hareket
- Laminlerden türbülansa geçiş aniden olmaz ve bir ara akış rejimi yaşanır.
- Türbülanslı akıştaki hızlı değişimlerin sonucunda, akışkanın yoğun bir şekilde karışması, akışkan parçacıkları arasındaki momentum geçişini artırır. Bu da yüzeydeki sürtünme kuvvetini ve dolayısıyla, gerekli olan pompa gücünü artırır. Akış tam gelişmiş olduğunda sürtünme katsayısı maksimum değerine ulaşır.

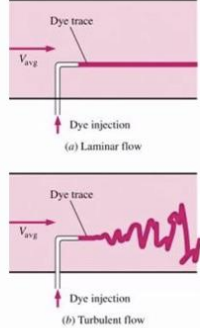

Join Audio Start Video Security Participants Chat **Share Screen** Record End

Share your screen by clicking the “share screen” button



WhatsApp Help: +90 552 394 02 00